

USER MANUAL

WET AND DRY CORDLESS VACUUM CLEANER

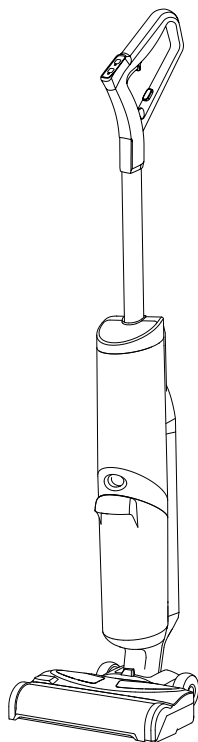

**READ ALL INSTRUCTIONS BEFORE USING YOUR
WET AND DRY VACUUM CLEANER.**

SAVE THIS MANUAL PROPERLY FOR NEXT TIME.

Thank you for using [Brand] Smart Multi-Surface Floor Wet Dry Vacuum Cleaner. Make your life better is our mission.

Please read this manual carefully as it contains important information on how to operate the cleaner safely, correctly and for optimal results.

This manual includes the latest information as of the time of printing, and [Brand] is solely responsible for the revision, interpretation and instruction of this manual.

We will continue to improve the products and reserve the right for changes without notice after printing the instructions.

Please feel free to contact us for your any questions or constructive suggestions via dial service hotline: (xxxxxxx), or E-mail to: (xxxxxxx)

Every single cleaner has been tested and inspected in prior to shipping to ensure they are qualified. A small amount of water vapor remains in the water tank and inside the vacuum is normal phenomena.

Index

• Important safety instructions	1
• Unit parts introduction	6
• Display panel introduction	6
• Assembly	7
• Recharge cleaner	7
• Lift-up	8
• Fill clean water tank	8
• Operation of cleaner	9
• Producing electrolyzed water	10
• Self-clean and drying	10
• Maintenance: Clean the dirty water tank components	11
• Maintenance: Rolling brush cleaning	13
• Fault diagnosis	14
• Specifications	15
• Customer service	16

Important safety instructions

READ ALL INSTRUCTIONS BEFORE USING YOUR CLEANER. WARNING!

To reduce the risk of fire, electric shock or injury:
It is imperative to observe basic precautions to use an
electrical appliance as following instructions:

1. This cleaner can be used by children aged from 8 years and above and persons with reduced physical, sensory or mental capabilities or lack of experience and knowledge if they have been given supervision or instruction concerning use of the cleaner in a safe way and understand the hazards involved. Cleaning and user maintenance shall not be made by children without supervision.
2. Children should be supervised to ensure they do not play with the cleaner.
3. Do not immerse your cleaner into water or liquid.
4. Keep hair, loose clothing, fingers, and all parts of body away from openings and moving parts of the cleaner and its accessories.
5. Do not use with damaged cord or plug. If appliance is not working as it should, has been dropped,damaged, left outdoors, or dropped into water, return it to a service center.
6. If the supply cord is damaged, it must be replaced by the manufacturer, its service agent or qualified person in order to avoid a hazard.
7. Do not burn the cleaner even though damaged seriously because the battery could be exploded on the fire.
8. Please dispose of the battery safely.
9. The batteries can only be replaced by the trained person.

10. In the case of excessive force, liquid may spill from the battery, avoid to touch the liquid, please flush with water if accident happen. If the fluid flies into your eyes, ask for medical help. The spilled liquid may cause pain or burns.
11. Charge only with the charger specified by the manufacturer. A charger suitable for one type of battery pack can cause a fire when mixed with another.
12. The battery must be removed from the unit before disposal.
13. Do not use damaged power cords or chargers.
14. If the cleaner does not work properly or has been dropped on the ground to be damaged, left outside or dropped in water, do not attempt to operate it and have it repaired at an authorised service center.
15. Use only the type and amount of liquids specified as instruction.
16. Liquid must not be directed towards equipment containing electrical components.
17. Do not pull or carry by cable, use cable as a handle, close door on cable, or pull cable around sharp edges or corners.
18. Do not unplug by pulling on cable.
19. To unplug, grasp the plug, not the cable.
20. Do not handle plug or appliance with wet hands.
21. Do not short-circuit the output terminal of the battery string or charger base.
22. **WARNING – To Reduce The Risk Of Electric Shock – Use indoors only.**
23. When removing the battery, disconnect the power supply of the device.
24. Do not charge, disassemble, heat (above 60 °C) or burn waste batteries.
25. Please dispose of the discarded battery in time.
26. Keep the battery out of reach of children.

27. Do not put battery in mouth. If swallowed by mistake, contact your physician or local poison control center.
28. To reduce the risk of injury from moving parts, assemble the rolling brush correctly in place before operation.
29. Do not put any object into openings.
30. Do not use with any opening blocked; keep free of dust, lint, hair, and anything that may reduce air flow.
31. Turn off all controls before unplugging.
32. Use extra care when cleaning on stairs.
33. Do not use to pick up flammable or combustible liquids, such as petrol, or use in areas where they may be present.
34. Do not suck toxic material (chlorine bleach, ammonia, drain cleaner, etc.)
35. Do not use cleaner in an enclosed space filled with vapors given off by oil base paint, some mothproofing substances, flammable dust, or other explosive or toxic vapors.
36. Do not suck hard or sharp objects such as glass, nails, screws, coins, etc.
37. Do not pick up anything that is burning or smoking, such as cigarettes, matches, or hot ashes.
38. Install the filter in proper before start the cleaner.
39. Do not use it outside of houses.
40. Do not store the cleaner in places where icing may occur.
41. Do not expose to rain. Store indoors.
42. Use only manufacturer's recommended attachments.
43. Do not allow to be used as a toy.
44. Keep cleaner on a level surface.
45. Please use the cleaning solution specified by manufacturer and use it in the specified proportion. Cleaning fluids that are not approved by us may cause damage and injury to users, the environment and parts inside the fuselage. We are not responsible for the consequences.

46. Prevent unintentional starting. Ensure the switch is in the off-position before connecting to battery pack, picking up or carrying the appliance. Carrying the appliance with your finger on the switch or energizing appliance that have the switch on invites accidents.
47. Do not use damaged or modified devices. Damaged or modified batteries can behave in unpredictable ways, resulting in a risk of fire, explosion or injury.
48. Do not expose the device to flame or excessive temperature. Exposure to flame or temperature above 130 °C may cause explosion.
49. Follow all charging instructions and do not charge the battery pack or appliance outside of the temperature range specified in the instructions. Charging improperly or at temperatures outside of the specified range may damage the battery and increase the risk of fire.
50. Repairing work must be conducted by qualified personnel and use only the same spare parts. This ensures sustainable product safety.
51. Do not modify or attempt to repair the device unless expressly stated in the instructions for use and maintenance.
52. Keep the temperature between 4 °C and 40 °C during battery charging, device storage, or device use.
53. Do not use without water tank or filters in place.
54. Carrying the appliance with your finger on the switch or energizing appliance that have the switch on invites accidents.
55. Use of any other battery packs may create a risk of injury and fire.
56. Do not run appliance over cord.
57. Keep cord away from heated surfaces.
58. Plastic film can be dangerous. Keep away from children to avoid danger of suffocation.

59. Use only as described in the user guide.
60. Do not use without dust bag and/or filters in place.
61. To Reduce the Risk of Fire, do not use a flammable or combustible liquid to clean a floor.
62. Recharge only with the adapter (US:YLS0251A-T300080; UK:YLS0251A-U300080; EU:YLS0251A-E300080; AU:YLS0251A-A300080; JP:YLS0251B-J300080;) and the battery pack specified by the manufacturer. Use of any damaged, modified, or any other battery packs and adapters may create a risk of injury and fire.

 **The model is for household use only.**

SAVE THESE INSTRUCTIONS

Unit parts introduction

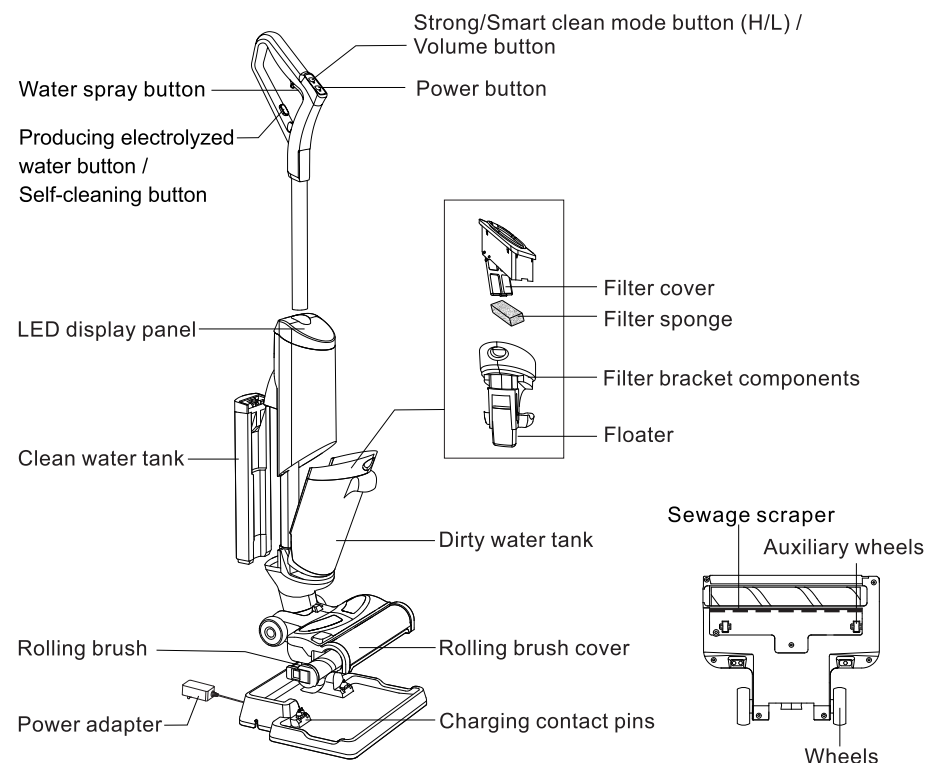

Display panel introduction

Display panel indicates status for battery charge, self-clean, clean water shortage, dirty water tank cleaning, clean mode.

Icon flashing: Brush jam/clean reminding
Icon is always on: Brush drying

Icon flashing: Clean water tank filling reminding
Icon is always on: Producing electrolyzed water

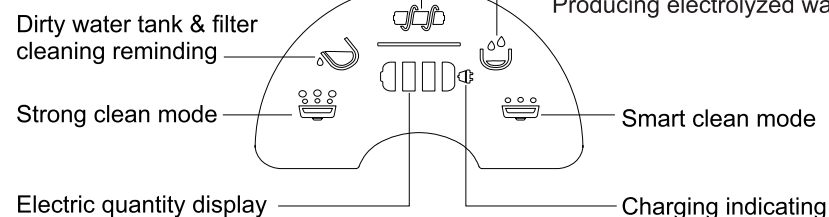

Assembly

The cleaner consists of 3 parts: handle, cleaner body and charging base, Please assemble cleaner as following steps after unpacking the box:

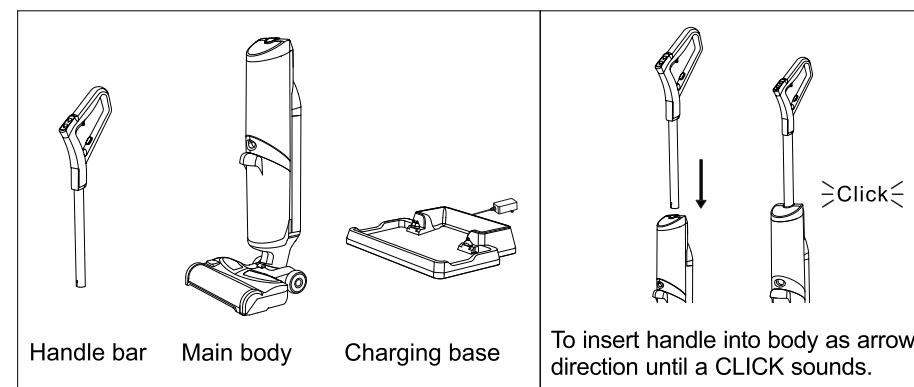

Recharge cleaner

To connect AC adapter plug of charge station to socket, put cleaner on charge station to charge until light on display panel to indicate the status of charging.

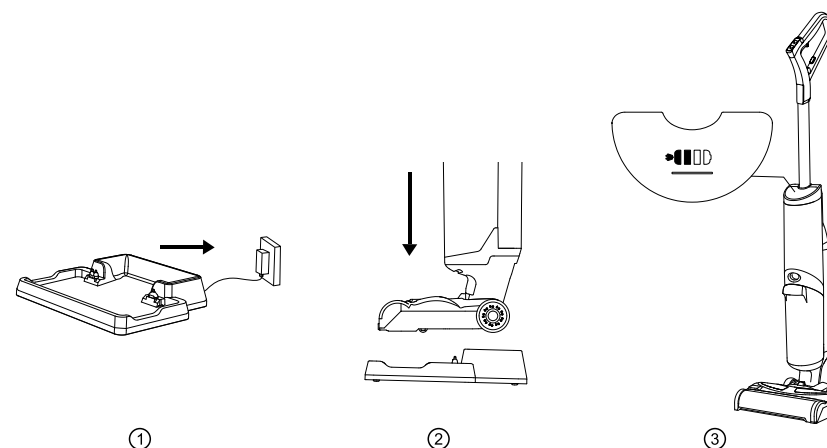

Lift-up

An ergonomics lift-up design has been applied on back of cleaner, we recommend you lift or move the cleaner via clasping Lift-Up position rather than holding the handle bar, avoiding cause connection loose to affect normal use.

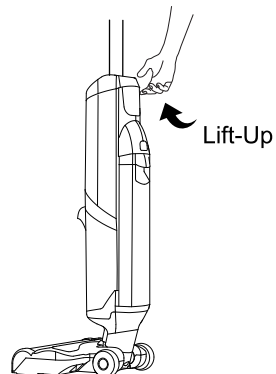

Fill clean water tank

To take clean water tank from cleaner and fill with clean water to the max line, then fill with 2 to 3 caps of formula ,seal with rubber cap, put the clean water tank back to cleaner.

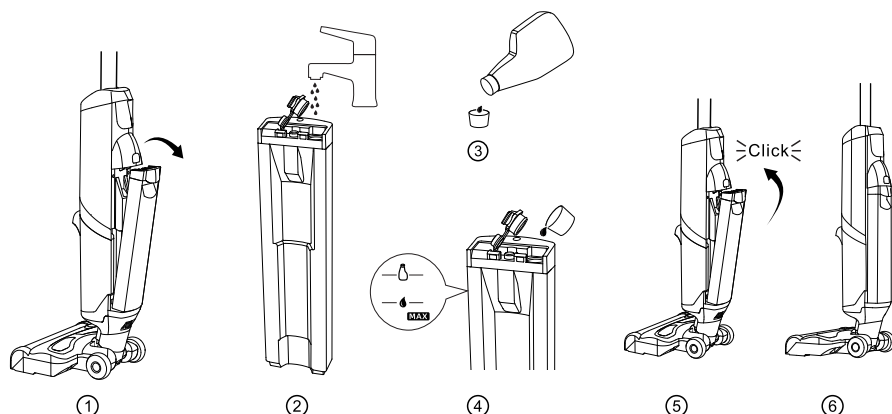

A few notes about filling the clean water tank:

Fill with hand hot (140°F / 60°C MAX) tap water and add the appropriate solution, non approval solution may cause the damage to the internal and other components permanently.

DO NOT USE BOILING WATER.

DO NOT HEAT WATER OR TANK IN MICROWAVE.

Operation of cleaner

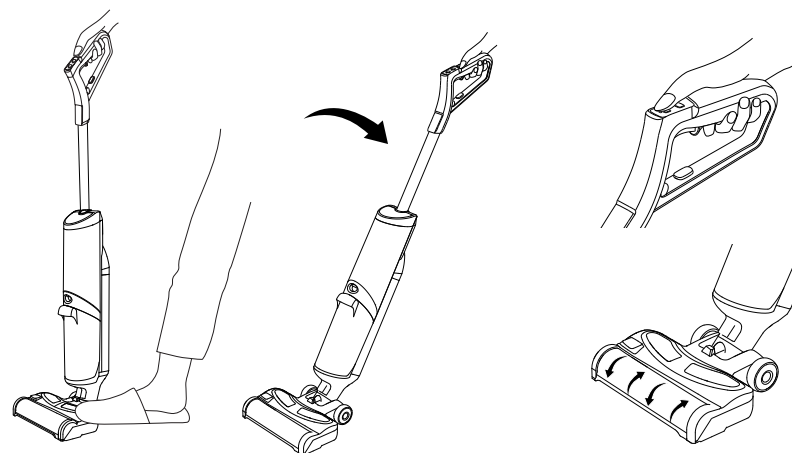

① Unlock and use: lightly press the pedal with your foot, pull the operating handle backwards.

② Press the power button to start cleaning.

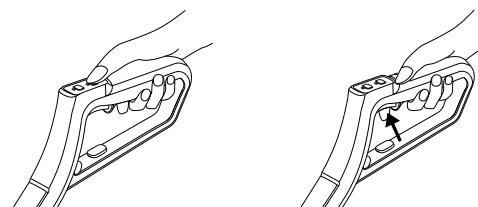

③ Press the "H/L" button to select strong clean mode or smart clean mode.

④ Press and then release the water spray trigger, the solution or clean water will wet the rolling brush.

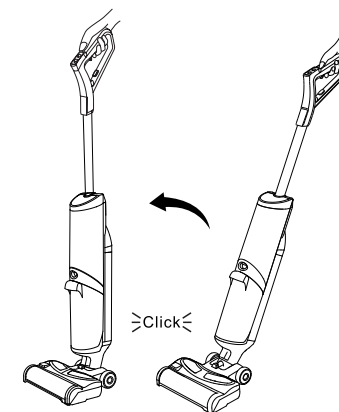

⑤ After floor cleaning, Press the power button to turn off. and push the handle frontward until a CLIKC sounds, the cleaner stand upright.

Note: Press the "H/L" button for 3 seconds to adjust volume.

Producing electrolyzed water

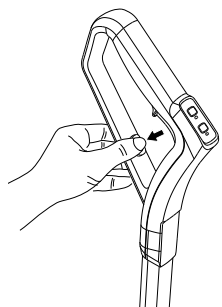

Short press producing electrolyzed water button to make. Automatically turn off after 3 minutes of activation. (short press again to close production.)

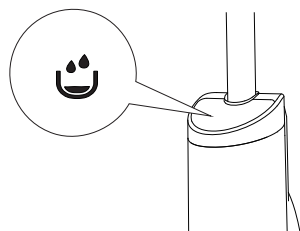

When producing electrolyzed water, The icon is always on.

Self-clean and drying

After floor cleaning, place the cleaner on charging base to power on, make sure batteries are well-charged and clean water is enough, then long press the self-cleaning button.

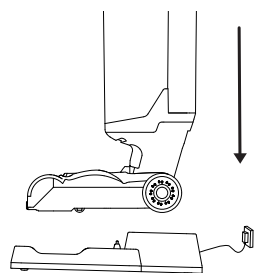

① Put the cleaner on charging base to power on.

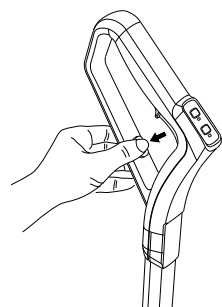

② Long press 3 second for self-cleaning. it will automatically produce electrolyzed water. There will be a short interval before the self-cleaning starts. After producing electrolyzed water it will automatically start self-cleaning and drying.

NOTICE:

When adding cleaning solution to the clean water tank, ensure to turn off the electrolyzed water production.

Maintenance: Clean the dirty water tank components

The floater is what prevents the dirty water tank from overflowing. When the dirty water tank is full, the floater will shut off the suction motor and produce a loud sound, indicating that the tank needs to be cleaned.

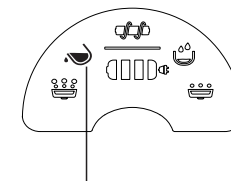

Dirty water tank & filter cleaning reminding

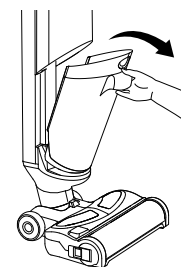

① Press the dirty water tank button, and remove the tank.



② Remove the filter bracket components upwards. Dispose of solid waste and empty the dirty water tank.



③ Flush the dirty water tank with cleaning brush.

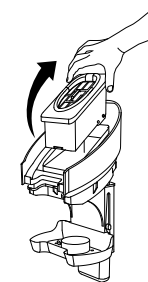

④ Remove the filter by pulling it up.

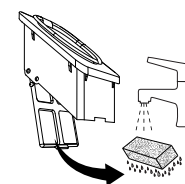

⑤ Open the mesh cover to take out the sponge, rinse and dry it.

Do not use sharp/hard force to scratch the inner surface.

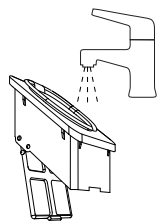

- ⑥ Rinse the filter screen.

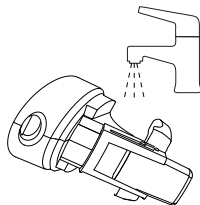

- ⑦ Rinse the filter bracket components.

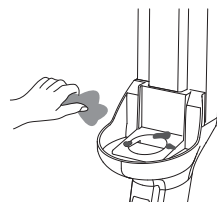

- ⑧ If the inside area where the dirty water tank sits is dirty, wipe it clean with a rag or towel.

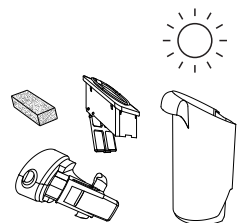

- ⑨ Leave parts out to dry.

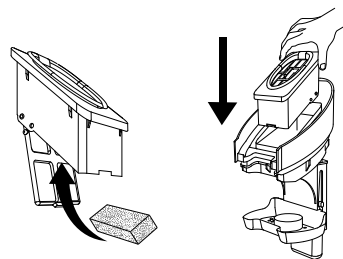

- ⑩ Place vacuum filter back into dirty water tank top.

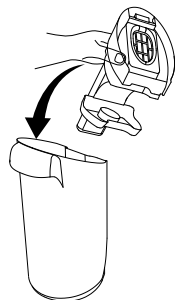

- ⑪ Once parts are dry, reassemble and replace the top of dirty water tank.

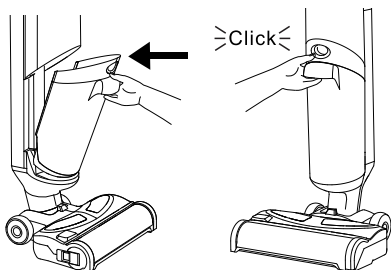

- ⑫ Place the dirty water tank back into body, inserting bottom first, Then tilt the top of the dirty water tank toward the machine and push into place until you hear a click.

NOTE: Make sure to clean dirty tank and let all components dry out after each use to keep your product at its best.

Maintenance: Rolling brush cleaning

NOTE: Turn off the cleaner before opening visible cover.

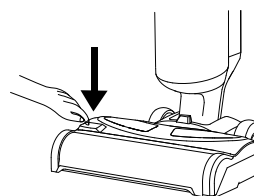

- ① Press the release button, and the rolling brush buckle will pop up.

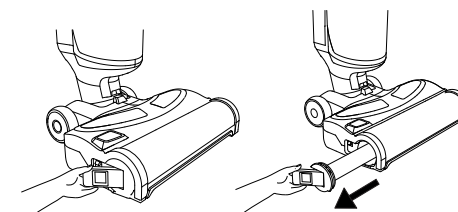

- ② Hold the rolling brush buckle and slowly pull out the rolling brush.

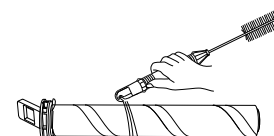

- ③ Use the hook to clean the tangled hair.

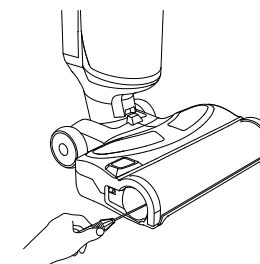

- ④ Insert a cleaning brush from the side for cleaning suction nozzle.

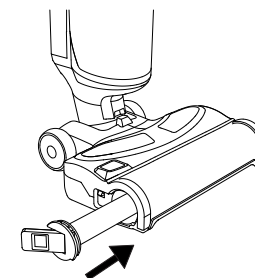

- ⑤ Reassemble the rolling brush. Insert it from the side, align the buckle to the slot position, then press the buckle to lock the rolling brush into place until a CLICK sound.

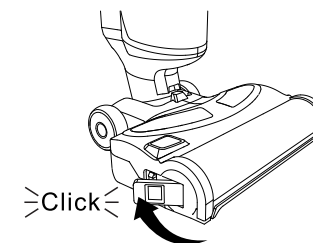

Fault diagnosis

You know?

Sometimes users will declare for maintenance because of non-product fault. Please confirm the following possibilities to help solve simple problems and determine whether it is a product fault.

In case of the cleaner doesn't work, it comes to following possibilities:

- ① Make sure battery no need to charge by watching charge light on display panel.
- ② Check the roller brush is locked in place.
- ③ Self-cleaning failed due to low power, so it needs to be charged to at least 1 bar of battery power.

In case of suction decline or abnormal noisy happen, it comes to following possibilities:

- ① Make sure no objects stuck in entrance places.
- ② Make sure dirty water tank relocates in place.
- ③ Make sure to clean thoroughly the dirty water tank unit and filter sponge.
- ④ Make sure that there is no excessive residual water in the filter sponge.

Note:

When using the cleaner in a near flat position, water from the dirty water tank may flow back into the body through the air inlet, causing damage to the motor. Therefore, the protective device float in the dirty water tank will block the air in let to protect the motor according to the usage situation. If the cleaner makes noise, please turn off the machine and place it upright. And then please also empty the dirty water tank. Once the float resets, it can be used again.

Specifications

Name	Wet and Dry Cordless Vacuum Cleaner
Model	VW 2203DH
Voltage	DC25.9V
Power	DC 200W
Battery SPEC	18650(7cells)
Battery volume	2600 mAh
Suction motor	BLDC
Suction power	15 kPa
Suction motor working setting	Standard
Roller brush speed	2550rpm
Working duration	28Mins.
Charging time	4H
Self-clean for roller brush	Available
Noise	70dBA
Clean water tank volume	550mL
Dirty water tank volume	600mL
Voice guide	Available
Net weight	3.4kg
Overall size	270*230*1130mm
Carton dimension	850*328*200mm
Using and charging temperature	4-40°C

ENVIRONMENT-FRIENDLY DIPOSAL



This symbol on the device or its packaging indicates:
Do not dispose of electrical appliances as unsorted municipal waste; use separate collection facilities. Contact your local authority for information regarding the collection systems available. If electrical appliances are disposed of in landfills or dumps, hazardous substances can leak into the groundwater and get into the food chain, damaging your health and wellbeing. When replacing old appliances with new ones, the retailer is legally obliged to take back your old appliance for disposal at least free of charge.

Customer Service

Warranty:1 year

Telephone:xxxxxxxx

Company Name:xxxxxxxx

Address:xxxxxxxx